

FORMING FACT



BIERSCHBACH EQUIPMENT & SUPPLY

1101 S LYONS AVE
SIOUX FALLS, SD 57101
1-800-843-3707

3030 N PLAZA DRIVE
RAPID CITY, SD 57709
1-800-658-5437

2121 LEECH AVE
SIOUX CITY, IA 51106
1-800-243-3707

4001 MAIN AVE
FARGO, ND 58103
1-800-540-2760

FORM ALIGNMENT: PART 1-WALERS

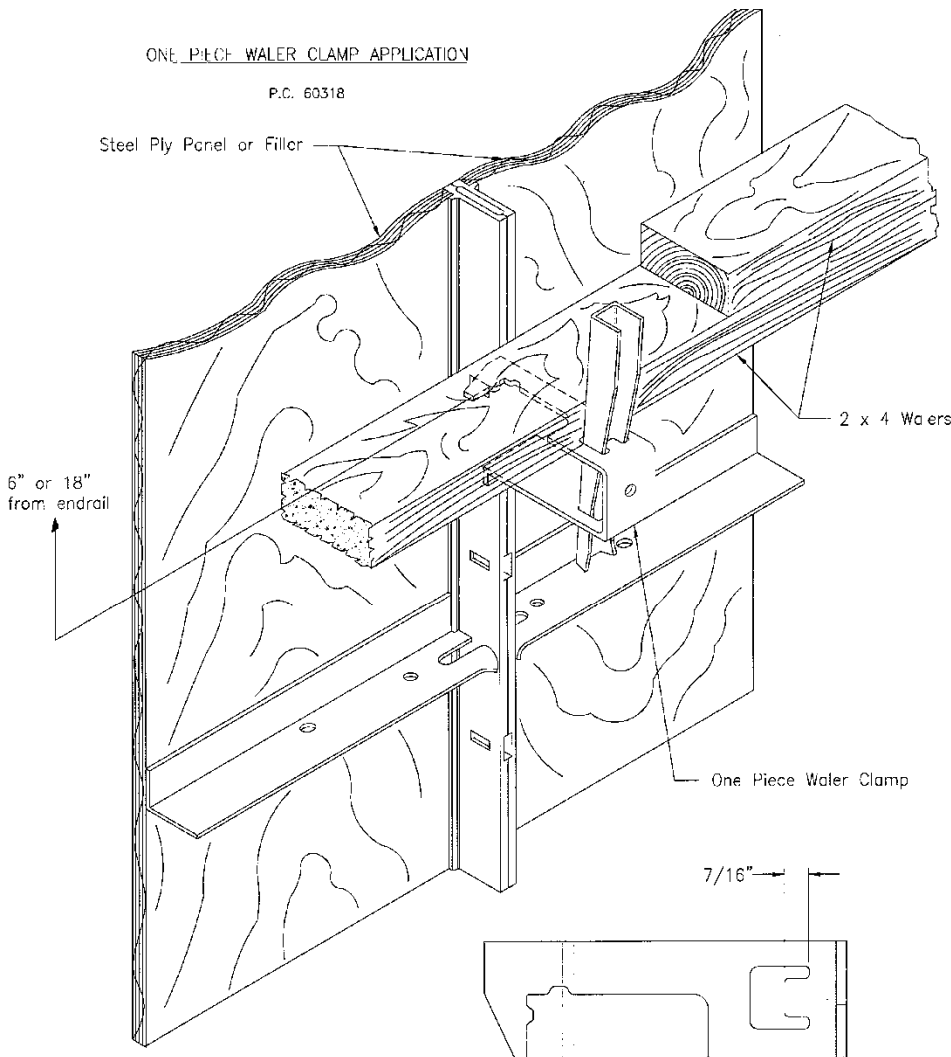

WALERS ARE USED FOR ALIGNMENT BASICALLY, AND IN MOST CASES DO NOT ADD TO THE STRUCTURAL ABILITY TO HOLD CONCRETE. BECAUSE OF THIS FACT, ONLY ONE SIDE OF THE FORMWORK SHOULD BE WALED. NORMALLY 2"X4" LUMBER IS USED FOR WALING MATERIAL. A TYPICAL WALER IS COMPRISED OF DOUBLE 2"X4"s, BUT THEY NEED NOT BE NAILED TOGETHER. WHEN APPLICABLE, 16' LENGTHS OF STRAIGHT LUMBER IS RECOMMENDED WITH THE JOINTS STAGGERED TO PROVIDE CONTINUOUS ALIGNMENT.



WEDGE GUIDE DETAIL

One Piece Water Clamps can ONLY be used as shown on this page.